

## WASHING MACHINE TEST SETUP



+91-9821075632 / +91-8373988100 :



[info@haptenbiotech.com](mailto:info@haptenbiotech.com) :



Plot no. 38 , Kh No 52/5 , Nangli Poona Village , Delhi-110036 :



## REFERENCE WASHER EXTRACTOR ( Wascator FOM71 CLS) :

<b>Make : ELECTROLUX</b>
Drum Volume : 61 Liter
Drum Diameter : 520 $\phi$ mm
Extraction, max : 1100rpm
G-factor, max : 350
Heating electricity : 5.4 kW
<b>At Ambient Conditions :</b>
Voltage : Nominal $\pm 2\%$
Frequency : Nominal $\pm 2\%$
Inlet water Cold : (15 $\pm$ 2) $^{\circ}$ c
Inlet water Hot : Max (60 $\pm$ 2) $^{\circ}$ c
Water pressure : (240 $\pm$ 50) kPa
Ambient temperature : (20 $\pm$ 5) $^{\circ}$ c
Inner Drum Diameter : (520 $\pm$ 1) mm
Inner Drum Depth : (315 $\pm$ 1) mm
<b>Inner Drum Lifting vanes: Number</b>
Inner Drum Dimension (HxRxW) : 53x17x65mm
Inner Drum Perforation : Diameter 5mm
Depth of Countersink : 2.5mm
Inner Drum Total Hole area : 600 cm <sup>2</sup>
Inner Drum Material : Stainless Steel 2333 (SS 18/8)
Outer Drum Diameter : 554mm
Outer Drum Sump : $\sim$ (1300 $\pm$ 25) ml
Outer Drum Material: Stainless steel 2333 (SS 18/8)

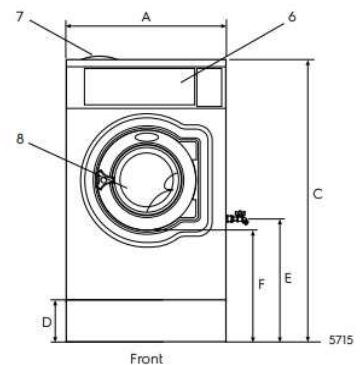

+91-9821075632 / +91-8373988100 :



[info@haptenbiotech.com](mailto:info@haptenbiotech.com) :



Plot no. 38 , Kh No 52/5 , Nangli Poona Village ,Delhi-110036 :



Door Opening diameter : 310 mm
Cabinet Material : Stainless steel 2333 (SS 18/8)
Drum washing Speed : (20 – 59±1) RPM (programable)
Drum Extraction : (200 – 1100±20) RPM (programable)
Reversing rhythm Programmable : (0 – 250±0.1) = sec.
Water level Weight sensing Repeatability : ±0.1kg/bath
Water level Weight sensing Stepsize : 0.05kg
Weight sensing Dosing accuracy weight control : ±0.2kg/bath
Water level sensing Repeatability: ±5 mm
Water level sensing Stepsize : 3 mm
Water level sensing Dosing accuracy level control : ±0.8litre/bath
Continuos variable in each wash sequence :Yes
Selectable interval : (4-97) °c
Programming steps :1 °c
Switch off temperature accuracy in Interval 30-97 °c : ±1 °c
Interval switch off temperature – switch on temperature : 4 °c
Water valves : 20 DN
Water pressure : 150-400 kPa
Capacity at 300 kPa : 20 l/min
Drain valve : 50/75 ø mm
Draining capacity : 150 l/min
Frequency of the dynamic force : 18.3 Hz
Floor load at max extraction : 1.6 ± 0.5 kN
Sound pressure level : 71 dB(A)

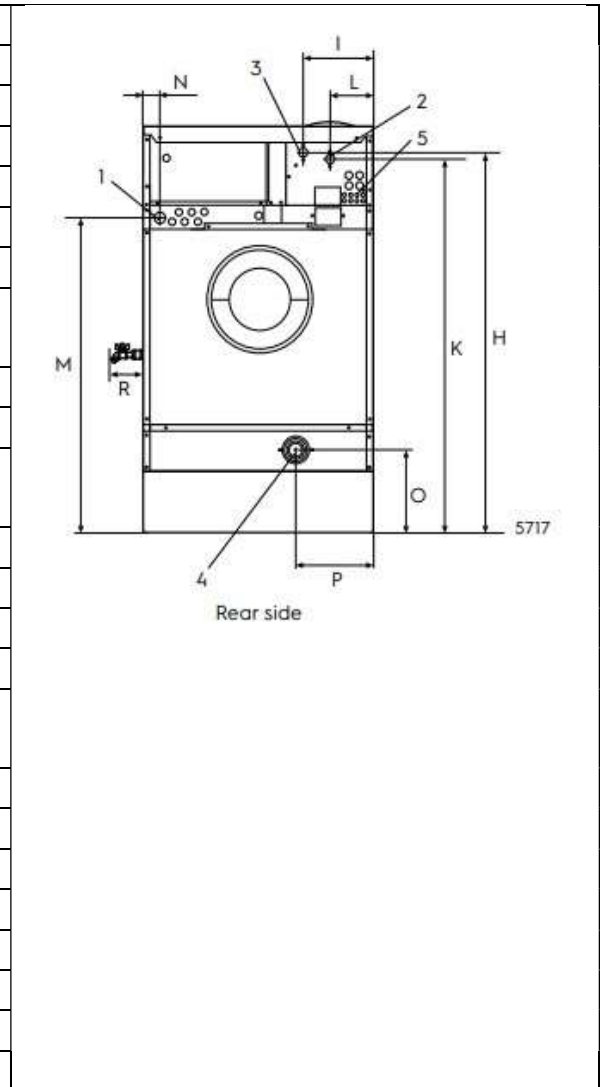

+91-9821075632 / +91-8373988100 :



[info@haptenbiotech.com](mailto:info@haptenbiotech.com) :



Plot no. 38 , Kh No 52/5 , Nangli Poona Village ,Delhi-110036 :



**Benchtop Spectrophotometer with Colour eye :**



Inter-instrument Agreement – $\Delta E^*$ avg (SCI) : 0.15
Repeatability RMS $\Delta E^*$ : 0.03
Photometric Resolution : 0.01%
Wavelength Range : 360-750 nm
Simultaneous Specular Included/Excluded : Available
Internal Temperature & Humidity Sensor : Available
Laser Transmission Targeting : Available

+91-9821075632 / +91-8373988100 :



[info@haptenbiotech.com](mailto:info@haptenbiotech.com) :



Plot no. 38 , Kh No 52/5 , Nangli Poona Village , Delhi-110036 :



**SPIN EXTRACTOR :**



**Integrated Power Analyzers & Data Logging system for Energy Consumption:**

<b>Integrated Power Analyzers &amp; Data Logging system for Energy Consumption</b>
Parameter : Voltage , Current , Power , Energy , Frequency
Voltage Range : 0-300V
Current Range : 0-10A
Frequency : 40-65 Hz

+91-9821075632 / +91-8373988100 :



[info@haptenbiotech.com](mailto:info@haptenbiotech.com) :



Plot no. 38 , Kh No 52/5 , Nangli Poona Village , Delhi-110036 :





### Digital Water Flow & Temperature Meters:

<b>Digital Water Flow &amp; Temperature Meters</b>
Digital flow meter with capacity 1-25L/m. With Digital Temp Meter .
Material : ABS
Display : LCD
Pressure Gauge : Conventional Analog (as per Specification)
Water flow can be recorded.

+91-9821075632 / +91-8373988100 :



[info@haptenbiotech.com](mailto:info@haptenbiotech.com) :



Plot no. 38 , Kh No 52/5 , Nangli Poona Village ,Delhi-110036 :



### Digital Weighing Machine:

<b>Weighing Balance ( Platform)</b>
Capacity : 30 kg
Readability: 0.1g
Pan Size (mm) : 250 X 250
Display : LCD
Pan : SS 202
Power Supply : AC 220V / 50-60 Hz

<b>PRECISION Balance</b>
Max. ( Capacity ):200 g
Readability ( d ):0.001 g ( 1mg )
Linearity: $\pm 0.002$ g
Display: LCD
Calibration: Automatic External Calibration
Class: Class I
Stabilization Time :3-5 Sec
Weighing Pan material:Stainless Steel
Pan Size (mm):80 mm
Tare Range: Full
Operating Temperature:+15° C to + 30° C
Weight :6 Kg
Key Sound: Yes
Weighing Chamber:240 x 190 x 265 mm
Interface: RS232C
Power Supply:AC 220V / 50-60 Hz
Dimension :(LxWxH) mm 415 x 405 x 295

**We also provide basic construction and wooden works.**

+91-9821075632 / +91-8373988100 :



[info@haptenbiotech.com](mailto:info@haptenbiotech.com) :



Plot no. 38 , Kh No 52/5 , Nangli Poona Village ,Delhi-110036 :

